

**NOTES:**

- DO NOT SCALE OFF DRAWING, REFER TO LISTED DIMS ONLY!
- ALL DIMS ARE FACE TO FACE OF SHEETROCK OR TO CENTERLINE OF DOORS AND WINDOWS UNLESS OTHERWISE NOTED. ANY DIMENSIONAL DISCREPANCIES SHALL BE BROUGHT TO THE IMMEDIATE ATTENTION OF THE EPOCH DESIGN DEPARTMENT FOR VERIFICATION.
- ROOM AREA CALCULATIONS ARE APPROXIMATE.
- F.C. TO PROVIDE PER CODE THE SEPARATION REQUIREMENT PER APP. BUILDING CODE OF THE EMERGENCY SWITCH & THE BOILER ON SITE.

EPOCH HOMES MANUFACTURES IT'S BUILDINGS TO CONFORM WITH THE FOLLOWING MASSACHUSETTS BUILDING CODES:

- MA FUEL/GAS/PLUMBING CODES.
- MA STATE BUILDING CODE, 6th EDITION.
- 1993 BOCA NATIONAL MECHANICAL CODE W/ MA AMMENDMENTS.
- 2005 NATIONAL ELECTRIC CODE W/ MA AMMENDMENTS.

ROOM SCHEDULE			
ROOM	SF	LIGHT	VENT
BEDROOM 2	160 SF	22	11
BEDROOM 1	155 SF	33	17
BATH 1	55 SF	0*	0*
LIVING	240 SF	52	34
KITCHEN	147 SF	8	8

\*MECHANICAL LIGHT/VENT.

DOOR SCHEDULE						
MANUF.	ID	TYPE	MATERIAL	SIZE	REMARKS	QTY
ARTEK	SF21	15 LITE	FIBERGLASS	2'-8" x 6'-8"	--	1
ARTEK	SF56N	4 PNL/WHHEEL LT.	FIBERGLASS	3'-0" x 6'-8"	--	1
PELLA	7281	SLIDER	ALUM. CLAD	6'-0" x 6'-9 3/4"	W/ GRILLES	3

\*EGRESS IN MA = MIN. 3.3 SF OPENING 20 X 24 IN EITHER DIRECTION

WINDOW SCHEDULE								
MANUF.	ID	TYPE	MATERIAL	RO WIDTH	RO HEIGHT	EGRESS*	REMARKS	QTY
PELLA	C214LR	CASEMENT	ALUM. CLAD	3'-7"	3'-6"	NO	--	1
PELLA	C2571	CASEMENT	ALUM. CLAD	2'-2"	6'-0"	YES	--	1
PELLA	DH294I	DOUBLE HUNG	ALUM. CLAD	2'-6"	3'-6"	NO	--	1
PELLA	DH3757	DOUBLE HUNG	ALUM. CLAD	3'-2"	4'-10"	YES	--	10
PELLA	CUSTOM	TRAPEZOID	ALUM. CLAD	2'-2"	5'-8"	YES	FIXED	1
VELUX	FS106	SKYLIGHT	WOOD/VINYL	1'-10"	4'-7"	NO	--	1
WEBB	OHV-2-0	OCTAGON	VINYL/WOOD	2'-1"	2'-1"	NO	--	1

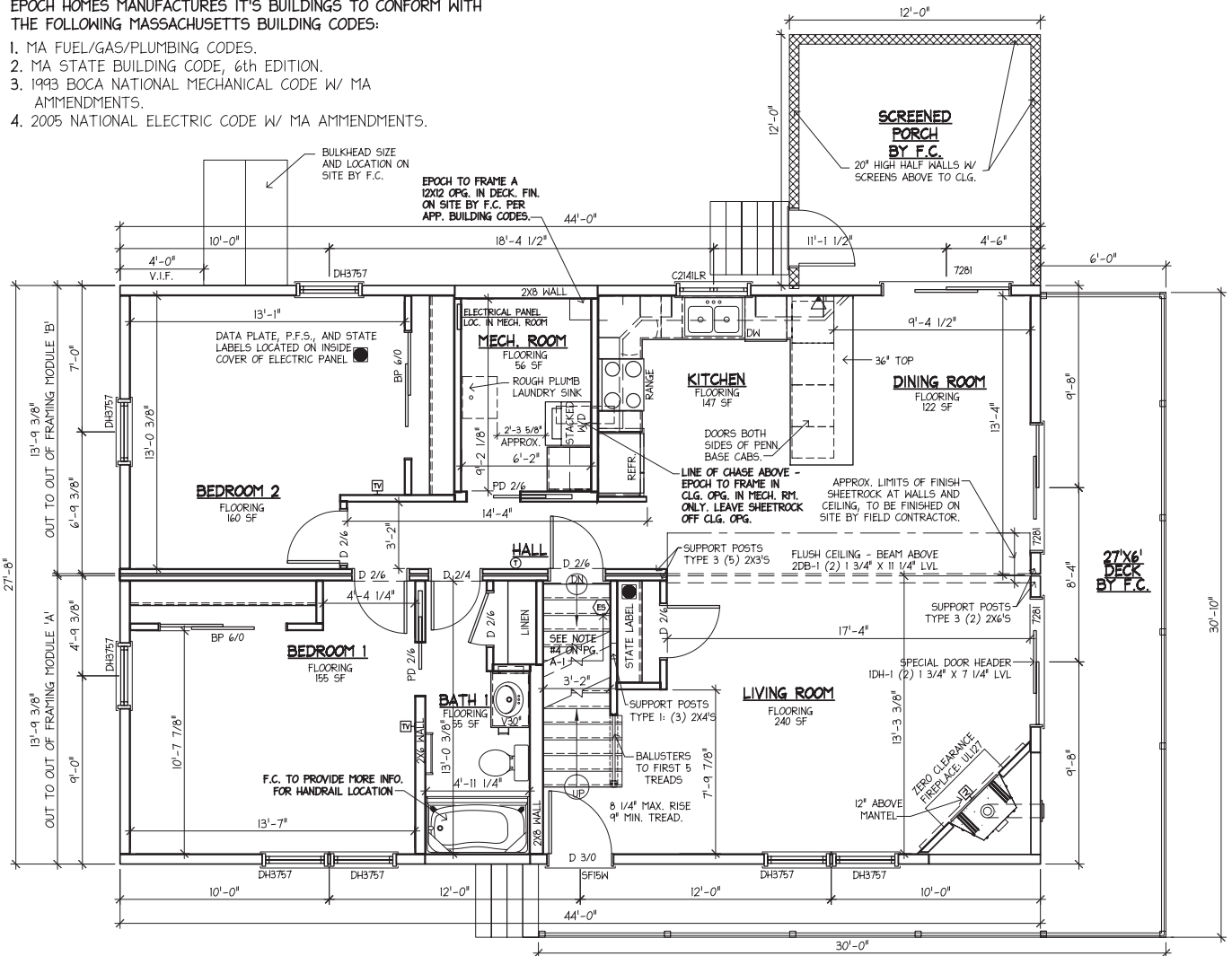

**P-1 FIRST LEVEL FLOOR PLAN**  
SCALE: 3/16" = 1'-0"  
CEILING HEIGHT = 8'-0"

NO.	DESCRIPTION	BY	DATE
1	PER PRRF 7/11/06	CAD	7/13/06
2	PER MARKED PLAN 7/31/06D	HN	8/2/06



ROUTE 106  
P.O. BOX 235  
PEMBROKE, N.H. 03275  
(603) 225-3907  
FAX: (603) 225-8329  
www.epochhomes.com

PROJECT:  
**28X44 CAPE**  
BUILDER:  
SOUTHEASTERN DEV. CO.  
33 EAST AVE.  
MARION, MA. 02738

NUMBER:  
**3946-06**  
ENDBUYER:  
MILLIGAN  
16 GLENN AVE.  
WAREHAM, MA. 02571

SHEET TITLE:  
**FIRST LEVEL FLOOR PLAN**  
DRAWN BY: CAD DATE: 6/23/06  
SCALE: AS NOTED

SHEET NUMBER:  
**A-1**

**NOTES:**

- DO NOT SCALE OFF DRAWING, REFER TO LISTED DIMS ONLY!
- ALL DIMS ARE FACE TO FACE OF SHEETROCK OR TO CENTERLINE OF DOORS AND WINDOWS UNLESS OTHERWISE NOTED. ANY DIMENSIONAL DISCREPANCIES SHALL BE BROUGHT TO THE IMMEDIATE ATTENTION OF THE EPOCH DESIGN DEPARTMENT FOR VERIFICATION.
- ROOM AREA CALCULATIONS ARE APPROXIMATE.

EPOCH HOMES MANUFACTURES IT'S BUILDINGS TO CONFORM WITH THE FOLLOWING MASSACHUSETTS BUILDING CODES:

- MA FUEL/GAS/PLUMBING CODES.
- MA STATE BUILDING CODE, 6th EDITION.
- 1993 BOCA NATIONAL MECHANICAL CODE W/ MA AMMENDMENTS.
- 2005 NATIONAL ELECTRIC CODE W/ MA AMMENDMENTS.

ROOM SCHEDULE			
ROOM	SF	LIGHT	VENT
BEDROOM 3	276 SF	33	17
BATH 2	68 SF	5	3

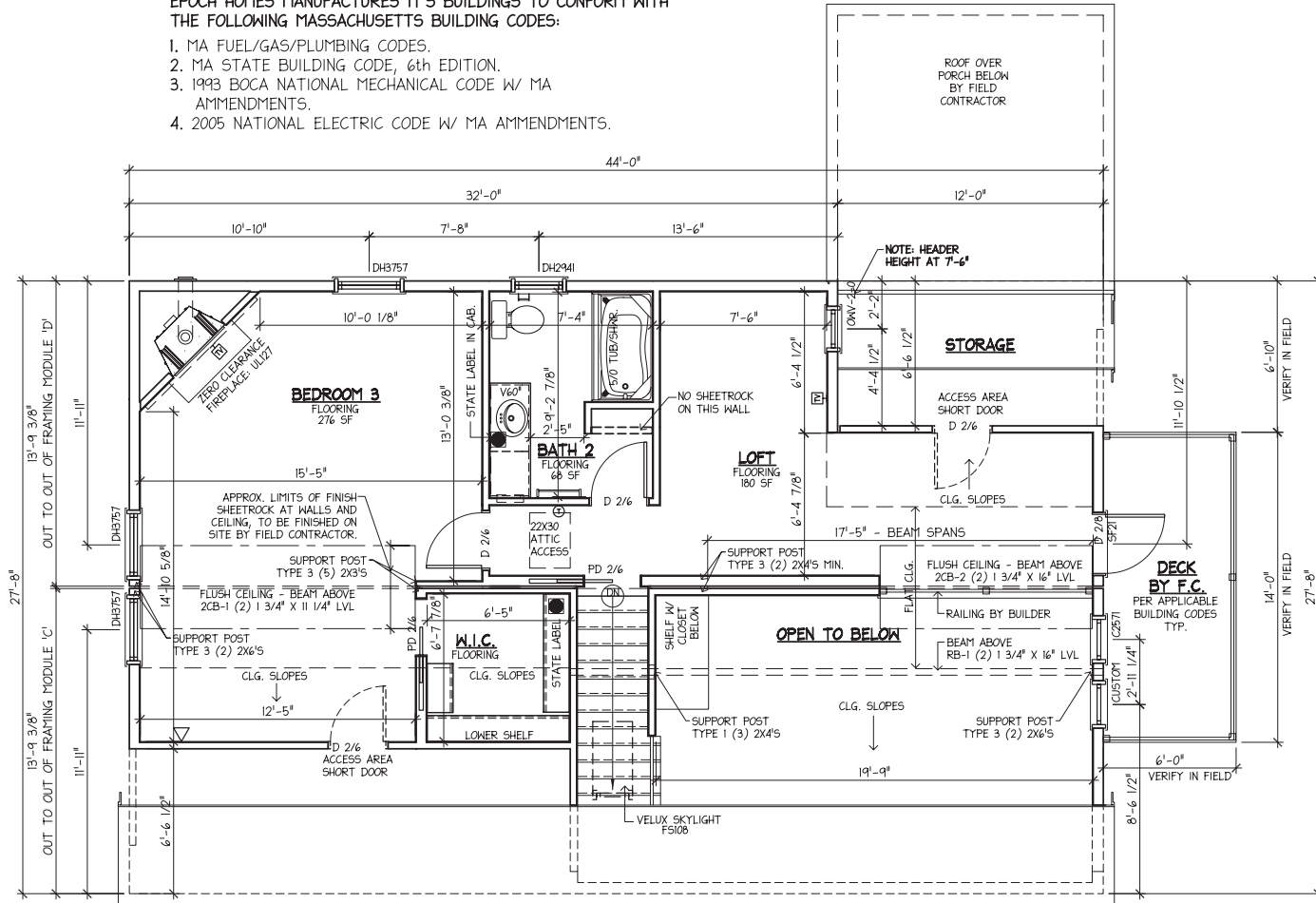

**P-1 SECOND LEVEL FLOOR PLAN**  
 SCALE: 3/16" = 1'-0"  
 CEILING HEIGHT = 8'-0"

NO.	DESCRIPTION	BY	DATE
1	PER PRRF 7/11/06	CAD	7/13/06
2	PER MARKED PLAN 7/31/06D	HN	8/2/06



ROUTE 106  
 P.O. BOX 235  
 PEMBROKE, N.H. 03275  
 (603) 225-3907  
 FAX: (603) 225-8329  
 www.epochhomes.com

PROJECT:  
**28X44 CAPE**  
 BUILDER:  
 SOUTHEASTERN DEV. CO.  
 33 EAST AVE.  
 MARION, MA. 02738

NUMBER:  
**3946-06**  
 ENDBUYER:  
 MILLIGAN  
 16 GLENN AVE.  
 WAREHAM, MA. 02571

SHEET TITLE:  
**SECOND LEVEL FLOOR PLAN**  
 DRAWN BY: CAD DATE: 6/23/06  
 SCALE: AS NOTED

SHEET NUMBER:  
**A-9**